

MORUŠE

1.PP

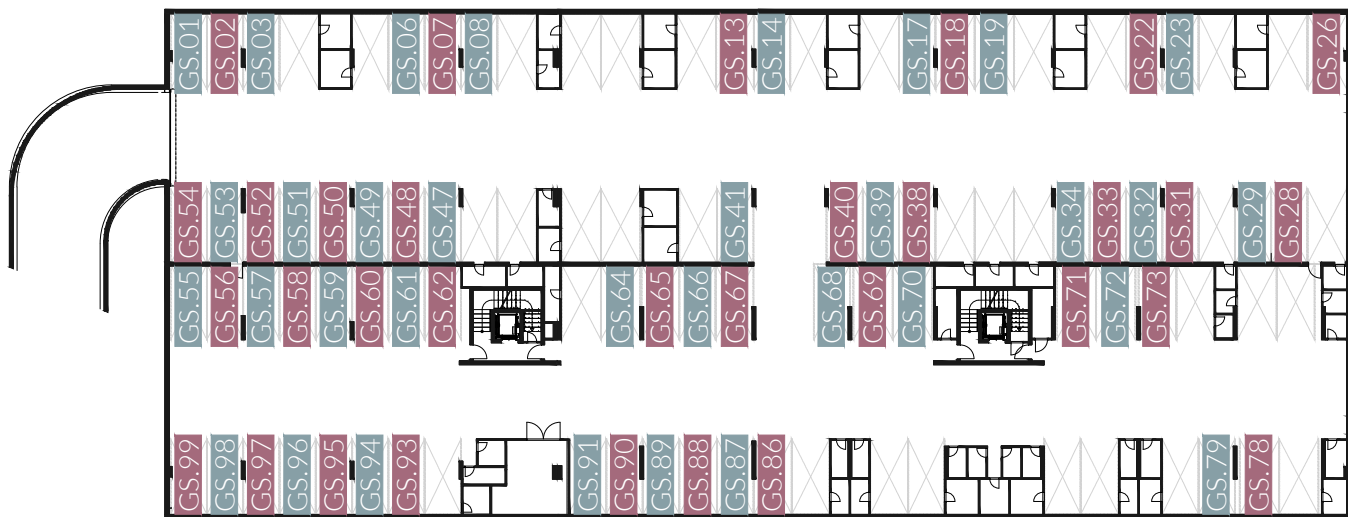

GS.01	/parking	GS.56	/parking
GS.02	/parking	GS.57	/parking
GS.03	/parking	GS.58	/parking
GS.06	/parking	GS.59	/parking
GS.07	/parking	GS.60	/parking
GS.08	/parking	GS.61	/parking
GS.13	/parking	GS.62	/parking
GS.14	/parking	GS.64	/parking
GS.17	/parking	GS.65	/parking
GS.18	/parking	GS.66	/parking
GS.19	/parking	GS.67	/parking
GS.22	/parking	GS.68	/parking
GS.23	/parking	GS.69	/parking
GS.26	/parking	GS.70	/parking
GS.28	/parking	GS.71	/parking
GS.29	/parking	GS.72	/parking
GS.31	/parking	GS.73	/parking
GS.32	/parking	GS.78	/parking
GS.33	/parking	GS.79	/parking
GS.34	/parking	GS.86	/parking
GS.38	/parking	GS.87	/parking
GS.39	/parking	GS.88	/parking
GS.40	/parking	GS.89	/parking
GS.41	/parking	GS.90	/parking
GS.47	/parking	GS.91	/parking
GS.48	/parking	GS.93	/parking
GS.49	/parking	GS.94	/parking
GS.50	/parking	GS.95	/parking
GS.51	/parking	GS.96	/parking
GS.52	/parking	GS.97	/parking
GS.53	/parking	GS.98	/parking
GS.54	/parking	GS.99	/parking
GS.55	/parking		



0 5 10 15 20 25 30 M 1:500

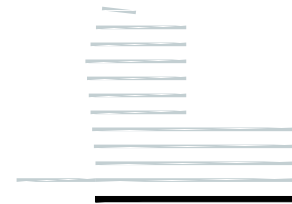

Upozornenie: Plochy jednotlivých miestností sú len orientačné. Do kôbiok a plochy parkovacích státi môžu zasahovať rozvody technickej infraštruktúry. Investor si vyhradzuje právo na drobné zmeny a na zmenu trasovania inžinierskych sietí objektu.

Note: This drawing is for illustration only. A network of technical infrastructure can interfere with a room volume of cellar, or parking space. The investor reserves the right to modify the design in a small degree and to technical infrastructure changes.